

# PHOBOS BT

ELECTROMECHANICAL OPERATOR FOR SWING GATES



Opens the future



UL 325  
COMPLIANT



#### • SMART TECHNOLOGY.

→ Control unit compatible with the EELink protocol.

#### • SAFE USE.

→ This version powered at 24V has been specially designed for simpler and faster installation in compliance with latest safety standards.

→ Thanks to the obstruction detection device, the operator reverses its motion and prevents damage to people and vehicles in the event of a contact.

#### • SIMPLER INSTALLATION.

→ BFT's system of coded limit switches makes it possible to reduce the complexity of wiring the low-voltage motors: a single wire is carried to the control panel instead of the three or five normally required, thereby increasing the simplicity and speed of installation. Furthermore, the system is able to automatically distinguish between the open limit switch and the closed one and hence prevent wasted time and wiring errors.

REFERENCE	DESCRIPTION	VOLTAGE	LEAF WEIGHT	LEAF LENGTH
R935246 00002	PHOBOS BT KIT UL/CSA SINGLE	24 V	up to 550 lb (~250 kg)	up to 10' (3 m)
R935246 00003	PHOBOS BT KIT UL/CSA DUAL	24 V	up to 550 lb (~250 kg)	up to 10' (3 m)
R935245 00001	PHOBOS BT L KIT UL/CSA SINGLE	24 V	up to 550 lb (~250 kg)	up to 16'5" (5 m) <small>with electric lock</small>
R935245 00002	PHOBOS BT L KIT UL/CSA DUAL	24 V	up to 550 lb (~250 kg)	up to 16'5" (5 m) <small>with electric lock</small>
P935066 00004	PHOBOS BT ARM	24 V	up to 550 lb (~250 kg)	up to 10' (3 m)
P935074 00003	PHOBOS BT L ARM	24 V	up to 550 lb (~250 kg)	up to 16'5" (5 m) <small>with electric lock</small>

## TECHNICAL FEATURES

	PHOBOS BT	PHOBOS BT L
CONTROL PANEL	LIBRA UL R	LIBRA UL R
REVERSIBLE/IRREVERSIBLE OPERATOR	irreversible	irreversible
POWER SUPPLY	120 V 60 Hz single-phase	120 V 60 Hz single-phase
ABSORBED POWER	0,05 hp (40 W)	0,05 hp (40 W)
THERMAL PROTECTION	integrated in the control unit	integrated in the control unit
ROD WORKING STROKE	11.6" (295 mm)	16.1" (410 mm)
ROD SPEED	0.78"/sec (20 mm/s)	0.78"/sec (20 mm/s)
OPENING AND CLOSING TIME	14 s	23 s
IMPACT REACTION	torque limiter integrated in the control panel	torque limiter integrated in the control panel
LOCK	mechanical on opening/closing	mechanical on opening/closing
MANUAL RELEASE	release key	release key
OPERATING CYCLE	intensive use	intensive use
ENVIRONMENTAL CONDITIONS	from -4°F (-20°C) to 140°F (+ 60°C)	from -4°F (-20°C) to 140°F (+ 60°C)
DEGREE OF PROTECTION	IP44	IP44
OPERATOR WEIGHT	11lb (~5 kg)	14.3 lb (~6,5 kg)
DIMENSIONS	see drawing next page	see drawing next page



**DIMENSIONS PHOBOS BT / PHOBOS BT L**

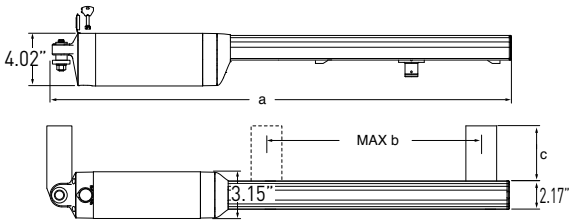

mm	BT	BT L
a	32.48"	37.13"
max b	11.61"	16.14"
c	2.67"	4.25"

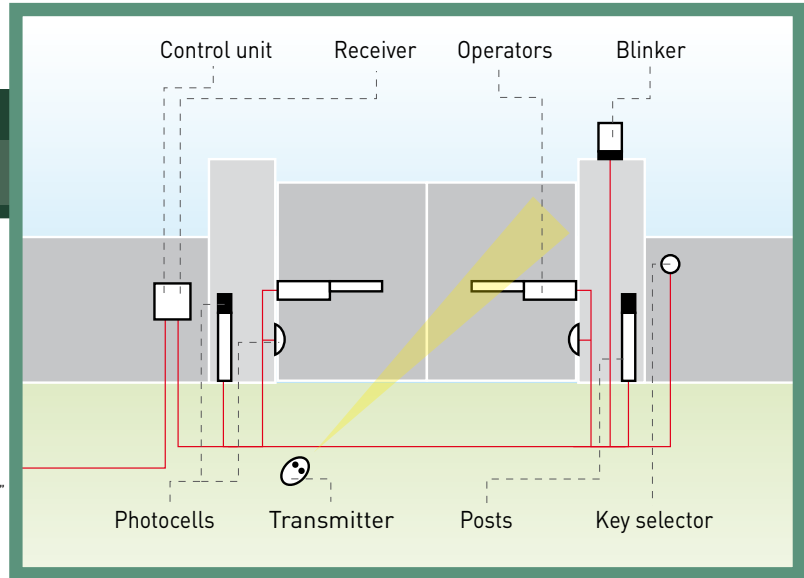

**ACCESSORIES**



**D113701 00001 - LIBRA UL R**

• Universal control panel for one or two 24V motors with 1 wire limit switch for each motor. • Quick wiring through plug-in terminal strips. • LCD display for quick programming and easy fault diagnosis. • Crushing prevention by electronic torque self-adjustment. • Built-in 63 remotes rolling code receiver. • Optional serial control management, solenoid electric lock and battery backup.



**KELIBRC00IU-LIBRA LARGE ENCLOSURE BOX**

Pre-wired 16"x14" enclosure box including battery back-up



**P125005 - BT BAT**

24 Vdc battery backup system for PHOBOS BT, PHOBOS BT L, IGEA BT it includes a charger board that activates the batteries when power is off and charges the batteries when power is on.



**P111323 - SCS**

Serial connection interface for LIBRA UL R.



**D111761 - ME BT**

12/24 Vac electric lock interface for ECB locks with BT operators.



**D121017 - ECB SX**

Left-hand horizontal electric lock. Also available in right-hand and vertical versions.



**D610180 - CLS/52**

Release key for LUX, PHOBOS BT, PHOBOS BT L and DEIMOS BT.

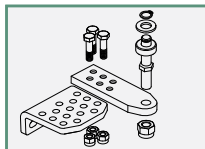

**P099838 - ARB PP**

Adjustable post bracket for PHOBOS BT / PHOBOS BT L



**D141297**

**Spare 3' (1m) cable**  
Cable for PHOBOS BT  
3 core wire